

1

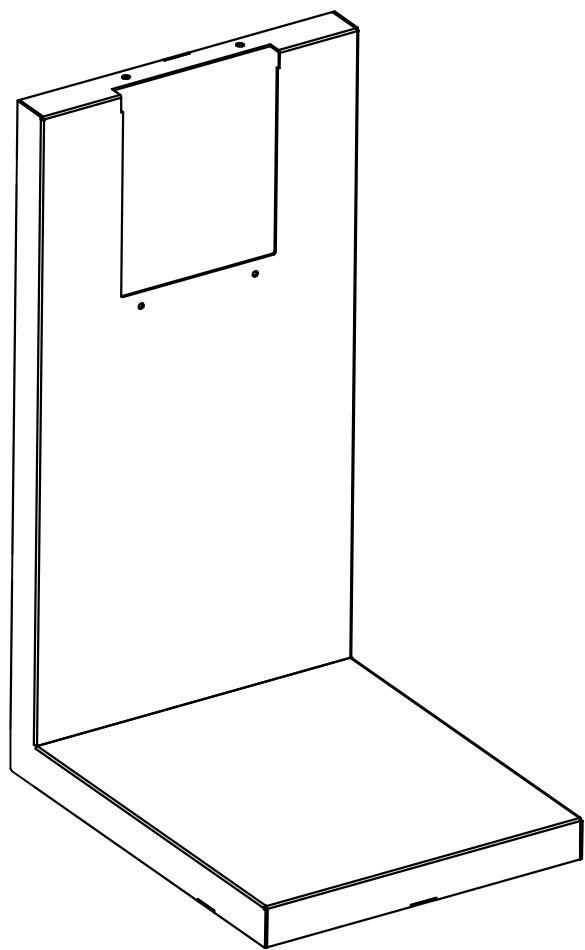

BASE

2

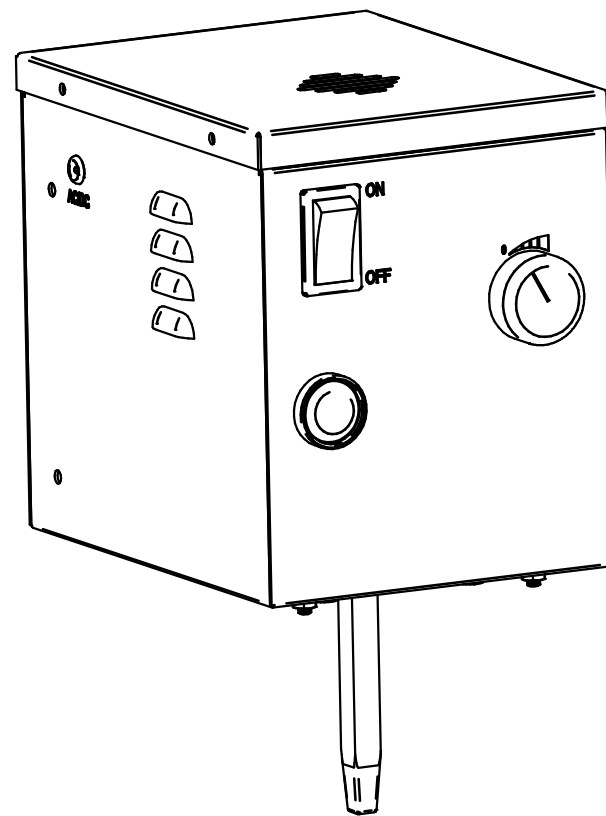

HEAD

3

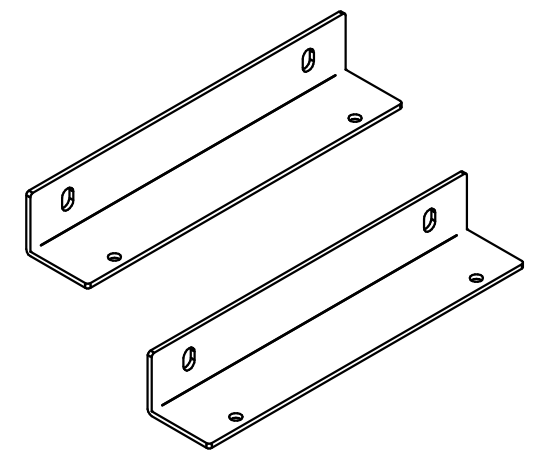

BRACKETS X2

4

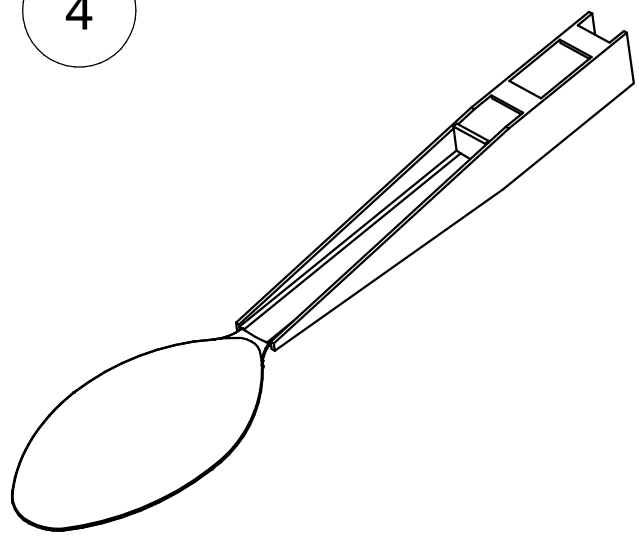

PLASTIC SPOON

5

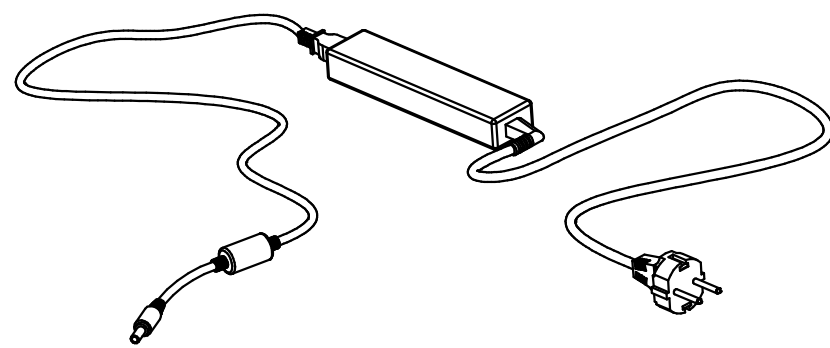

AC/DC ADAPTER

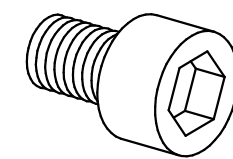

ELEN BOLT (x4)

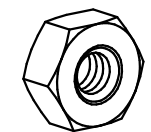

HEX M5 (x4)

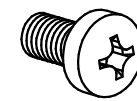

SCREW M3-6 (x12)

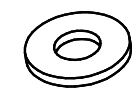

WASHER M3 (x12)

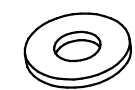

WASHER M4 (x4)

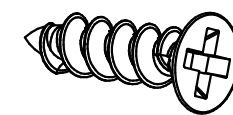

SCREW (x4)

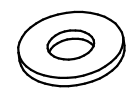

WASHER FOR ELEN (x4)

MULTIMIX MACHINE STRUCTURE

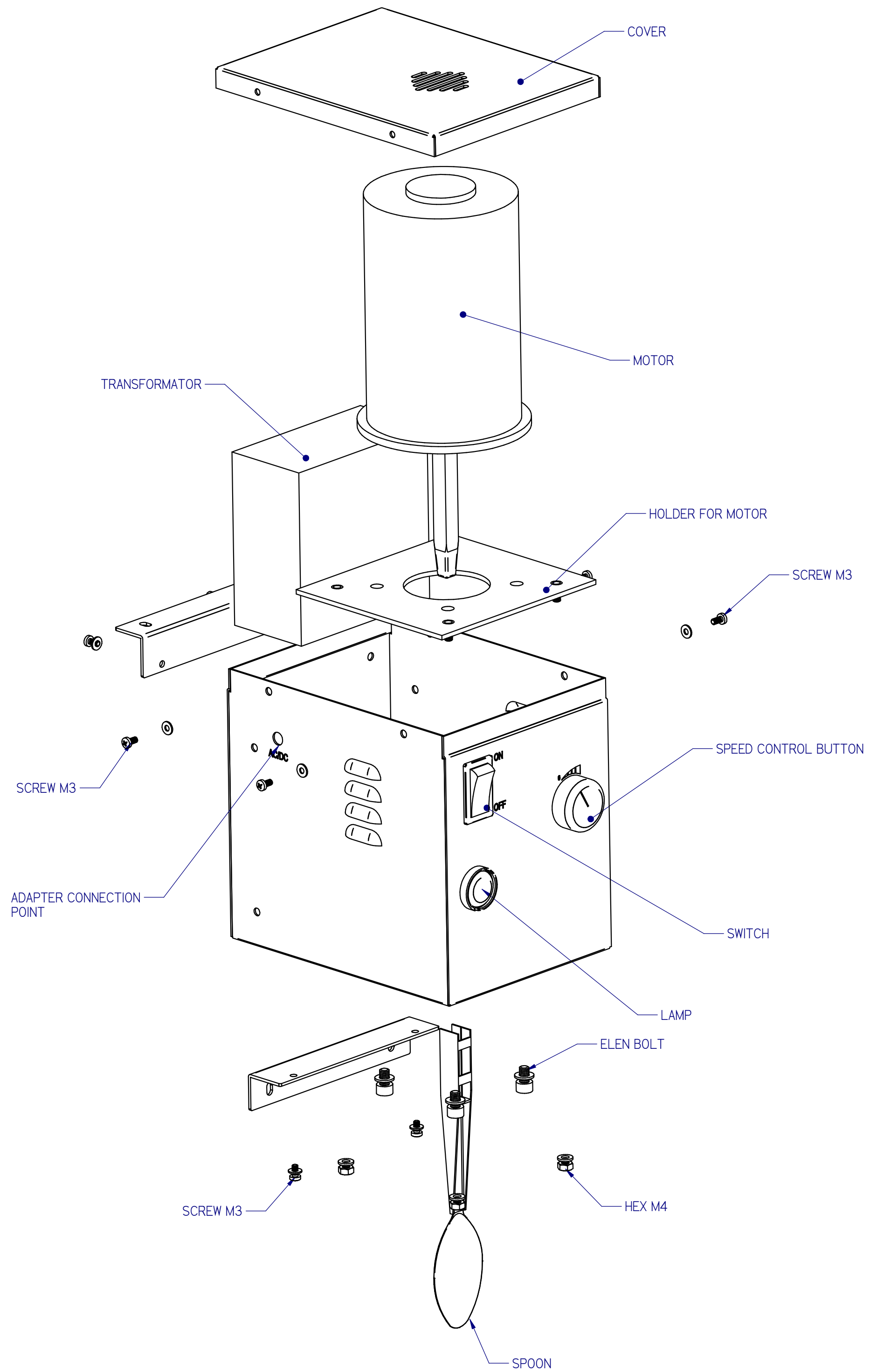

CONNECTING HEAD TO BASE

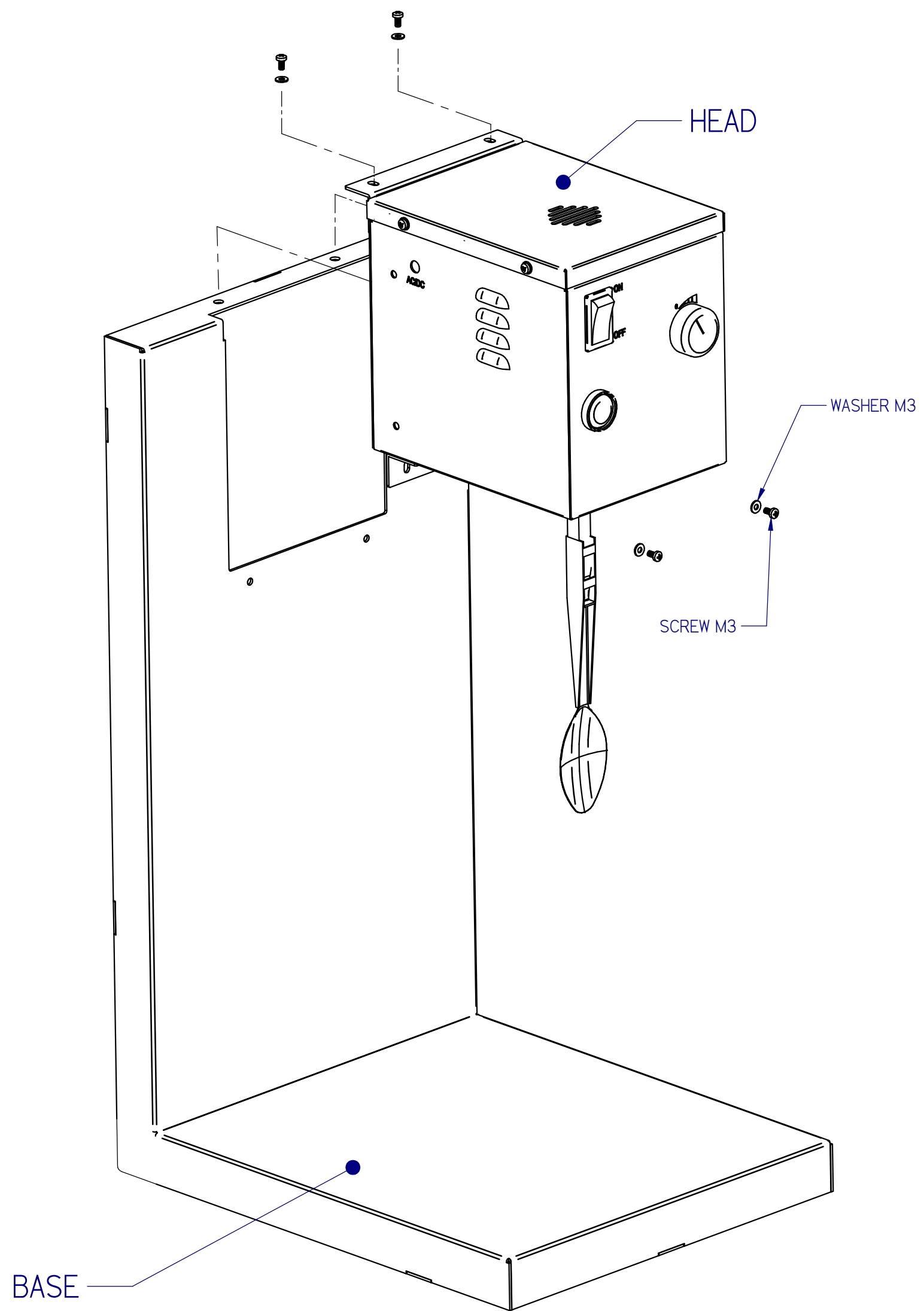

MOUNTING MACHINE HEAD TO WALL

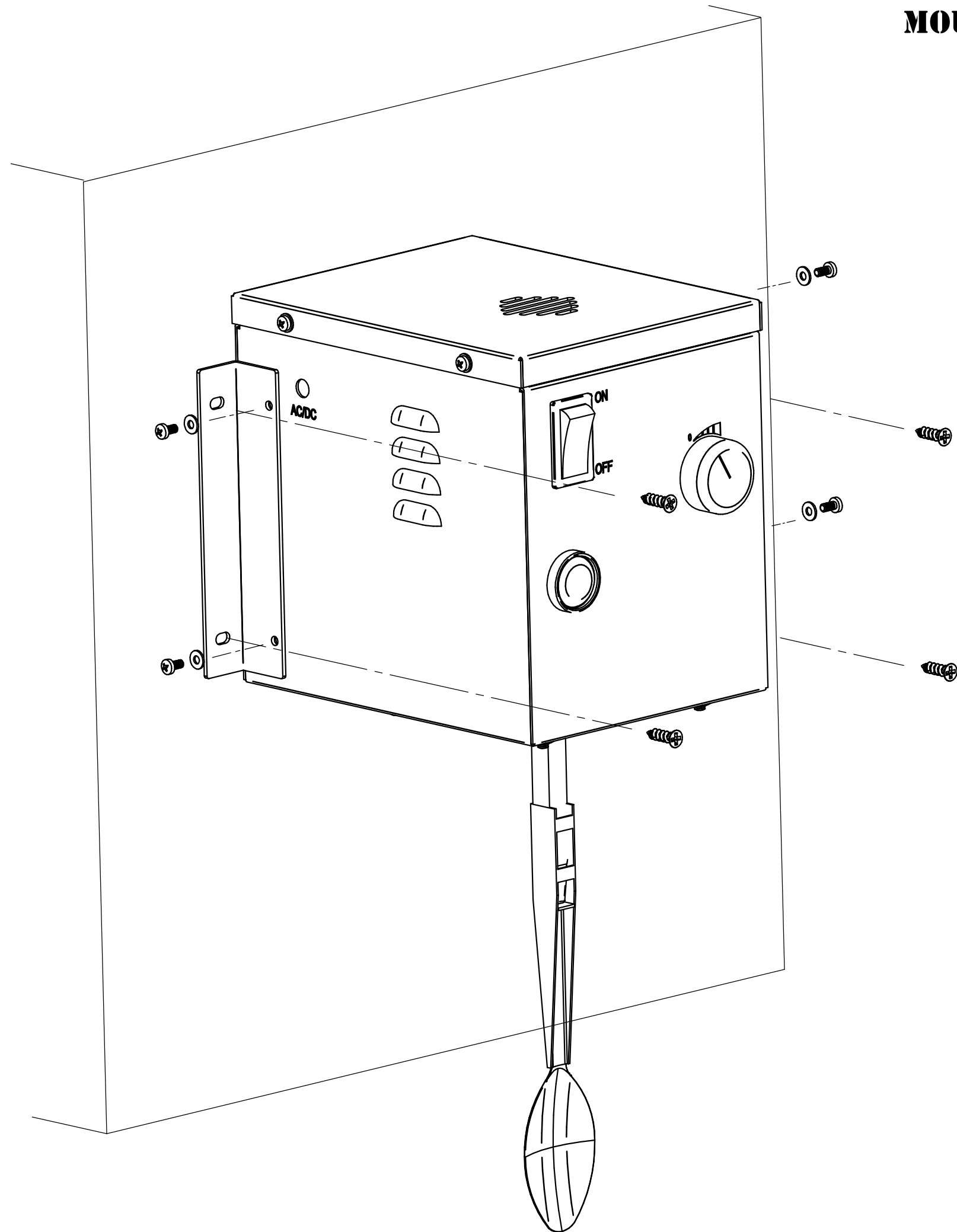

Step 1:

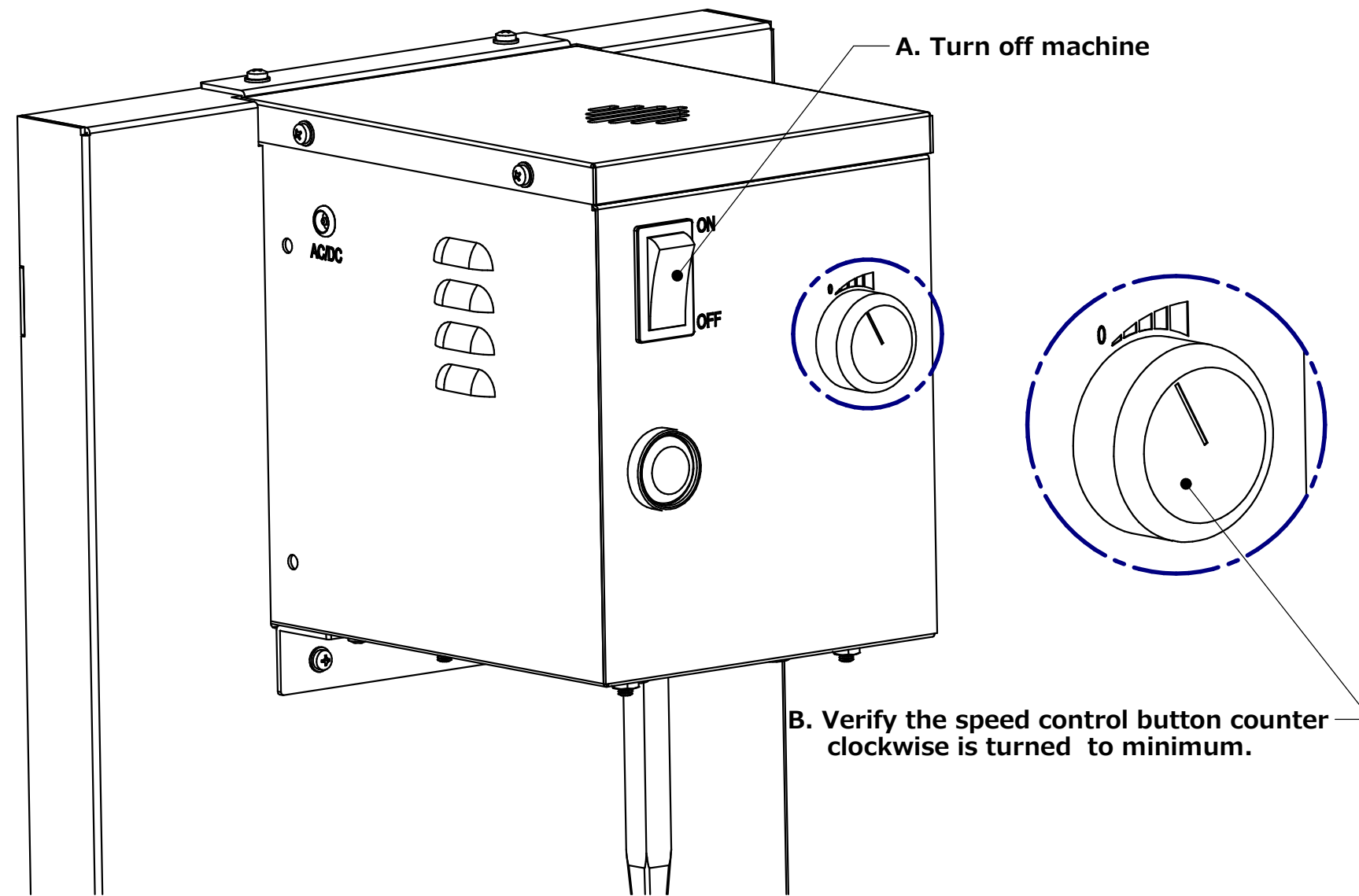

Step 2:

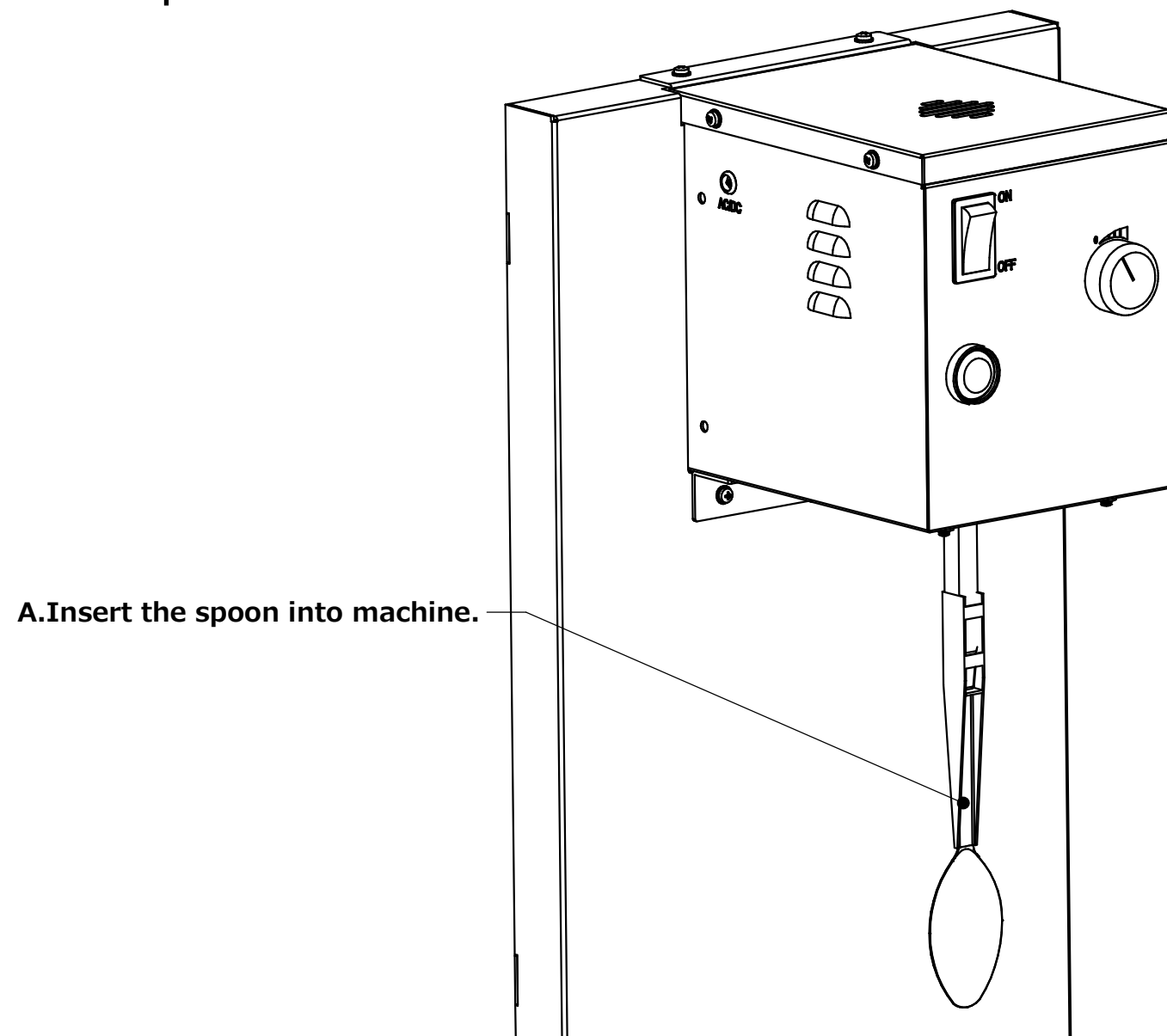

Step 3:

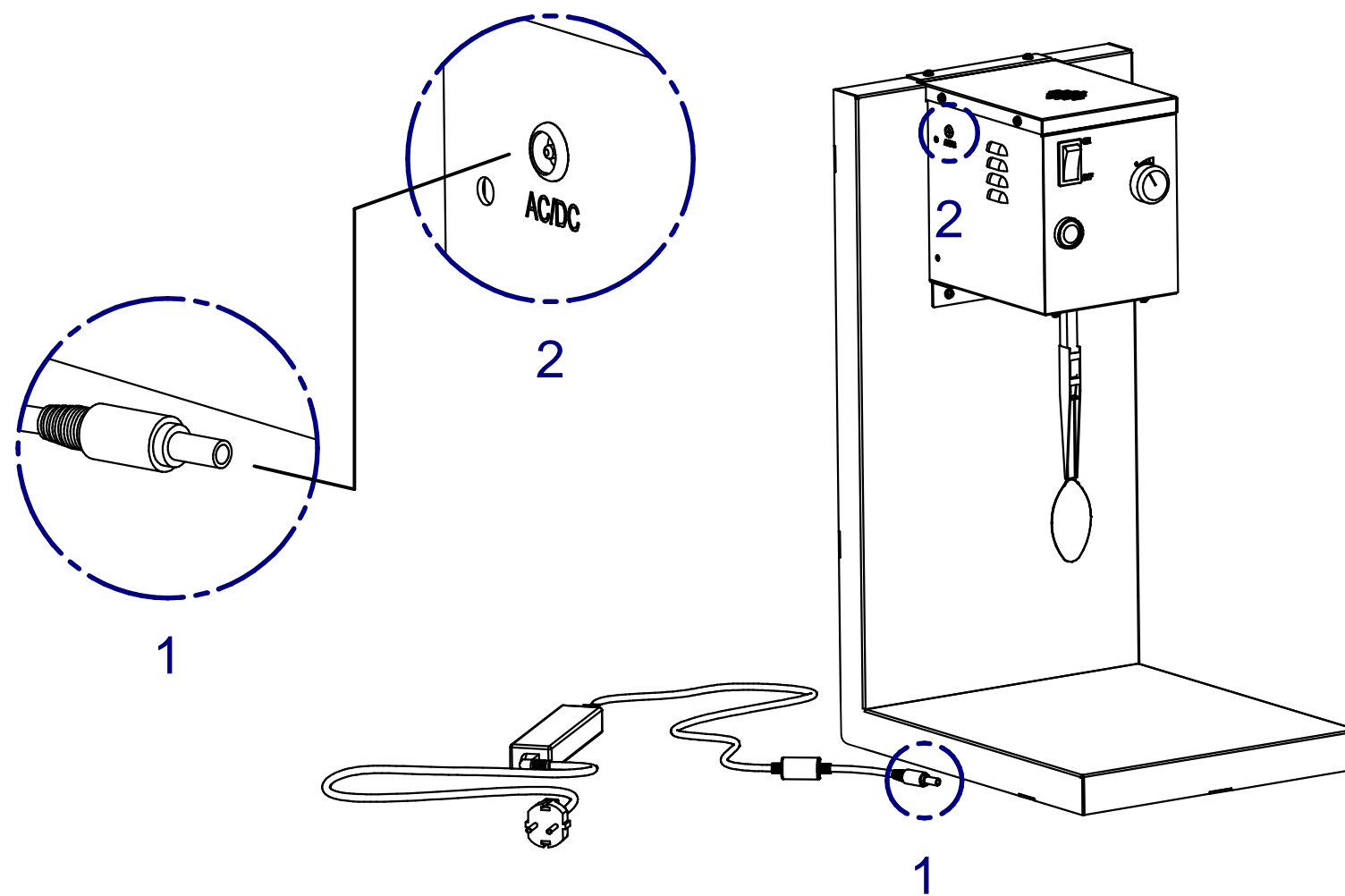

- a. Plug Machine Cable to the machine connection point (see image "1", "2")
- b. Plug AC/DC Adapter cable to Electric Power

Step 4:

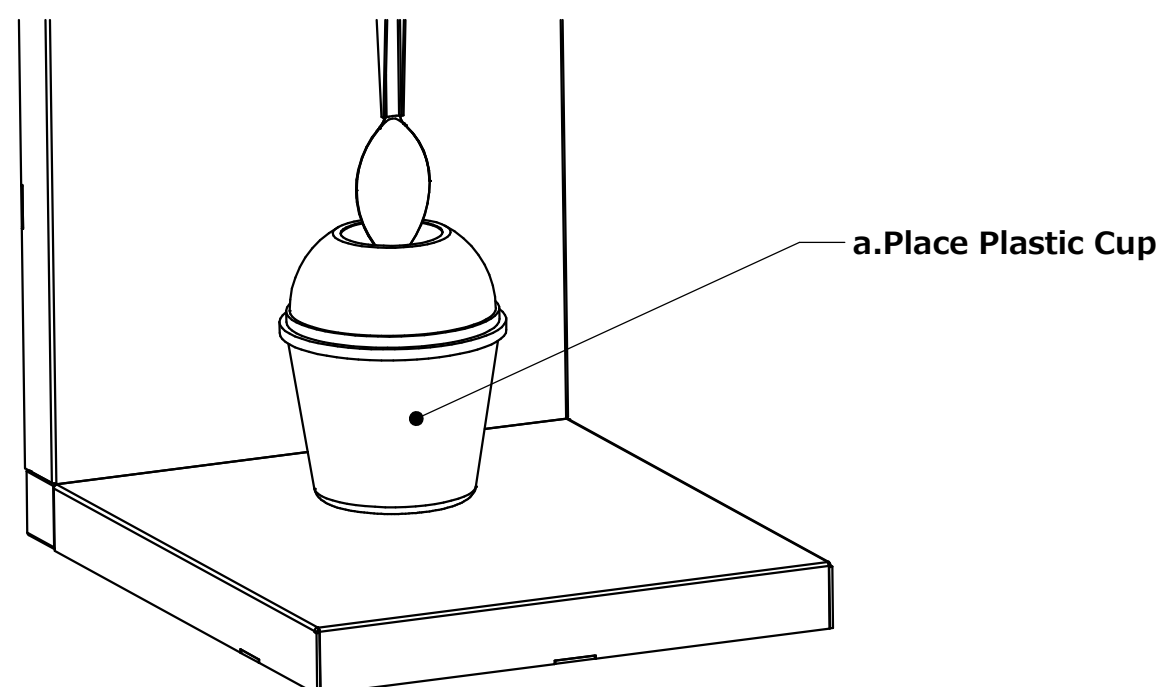

Step 5:

- a. Switch on Machine
- b. Slowly adjust speed control button clockwise to suit machine function requested